



# GLASBOND Fast-Tracks a Contractor Win for Pizza World Cedar Rapids Reopening

## GLASBOND Self-Adhered FRP Wall Panels

GLASBOND® represents a groundbreaking advancement in FRP (Fiberglass Reinforced Plastic) wall panel solutions. Designed for environments requiring high hygiene standards, GLASBOND features a pre-applied adhesive backing that eliminates the need for traditional glue. Key features include faster installation, minimal cleanup, a singular warranty for system integrity, and compliance with stringent health and safety standards, making it ideal for restaurant settings.

**“We developed GLASBOND in direct response to contractors’ needs for faster, cleaner installations while maintaining the hygiene, performance, and durability our customers have come to expect from our FRP.”**

**Jake Butman**

Crane Composites | Product Manager

### THE CONTRACTOR’S CHALLENGE

Pizza World, a highly popular pizza restaurant in Cedar Rapids, Iowa, was relocating to a new site quickly and needed a hygienic, durable wall solution for its kitchen and dining areas. Greg Garman, President of Garman Built, a leading local contractor, faced the challenge of meeting the restaurant’s tight timeline to reopen. The project required a wall system that was easy to install, low maintenance, compliant with health regulations, and visually appealing. Speed was critical since any delay would impact the restaurant’s ability to resume operations.



### THE INSTALLATION SOLUTION

Greg discovered GLASBOND through Burke Blanchard, Branch Manager at Foundation Building Materials (FBM) in Cedar Rapids. The distributor introduced GLASBOND as a superior alternative to traditional FRP panels, highlighting its pre-applied adhesive that eliminates the need for messy glue application. Garman chose GLASBOND because its hygienic properties are comparable to conventional FRP but with significant advantages in installation speed and reduced cleanup. The labor savings and faster project completion were key selling points for the restaurant owner, who was eager to reopen quickly.

Installation involved approximately 40 sheets of 4x10 GLASBOND panels. The contractor used standard roller and shears tools and required no specialized training. The pre-applied adhesive allowed for easy adjustments during installation, enabling the team to peel back and realign panels as needed. FBM helped facilitate a smooth transition from traditional FRP to GLASBOND by providing product education while also ensuring timely material availability.



### THE RESULT

The GLASBOND installation proved to be a game-changer. Garman noted significant time and labor savings since the adhesive-backed panels required virtually no cleanup compared to glue-based FRP systems. The ability to adjust panels during installation enhanced precision and efficiency. The finished walls met health standards, offered excellent durability, and required minimal maintenance, ensuring a clean and professional appearance for the restaurant.

Garman expressed high satisfaction with GLASBOND, stating they would choose it over traditional FRP for future projects. The restaurant owner was pleased with the quick turnaround, allowing the business to reopen ahead of schedule. Blanchard emphasized the product’s reliability, noting that feedback from other contractors has been overwhelmingly positive, particularly regarding ease of installation and time savings. The singular warranty covering both panel and adhesion is a significant



advantage, as it simplifies potential issue resolution compared to traditional systems that only offer warranties for panels.

**“Time savings without compromising on quality craftsmanship and materials is critical in our business. GLASBOND gave us faster and cleaner installation and gave our customer more time to move back in quickly and keep his business moving.”**

**Greg Garman**  
Garman Built | President



## THE CONCLUSION

The successful installation of GLASBOND at the Pizza World Cedar Rapids restaurant showcases its positive impact on commercial projects. With faster installation, minimal cleanup, and a reliable warranty, GLASBOND delivered exceptional value for both the contractor and the restaurant owner. For more information, visit Crane Composites at [GLASBOND.com](http://GLASBOND.com).

**“In just a few months, the response has been completely positive. We’ve seen sufficient use in the field to confirm that GLASBOND’s installation is both easy and fast without sacrificing its reliability and performance. It’s a great product from a trusted company that leads in FRP innovation.”**

**Burke Blanchard**  
Foundation Building Materials  
Branch Manager



**Faster and easier to install.**

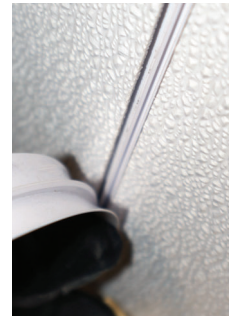
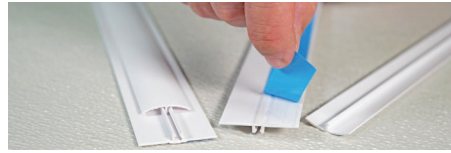

## PEEL + STICK PANELS UP TO 60% FASTER INSTALL

RESULTS BASED ON  
2,000 sf JOB (roughly 50 panels)

Panel Selling Price

**GLASBOND**

**Traditional FRP**

\$6,780

\$3,360

Adhesive Price

N/A

\$ 857

**Total Material Cost**

**\$6,780**

**\$4,217**

Installation Cost

includes installation (\$80/hr rate)  
+ glue wastage and cleaning

\$ 960

\$3,640

**Total Cost Installed**

**\$7,740**

**\$7,857**

Total SF Cost Installed

\$3.87

\$3.93

Total Man Hours

12 hours

40 hours

## SAVE \$120 AND 28 HOURS

by utilizing GLASBOND vs. traditional frp

**WHAT WILL YOU DO WITH YOUR TIME SAVINGS?**

compare your own results with our full calculator at  
[cranecomposites.com/GBNDcalculator](http://cranecomposites.com/GBNDcalculator)



**Stronger than ever.**

SCAN TO COMPARE YOUR OWN RESULTS WITH OUR FULL  
CALCULATOR AT [cranecomposites.com/GBNDcalculator](http://cranecomposites.com/GBNDcalculator)

A global leading provider of resilient wall and ceiling coverings. Kemlite® was established in 1954 and the company changed names to Crane Composites in 2007. Crane Composites is headquartered in Channahon, IL and all our products are manufactured in the United States. We work with hundreds of distributors, ensuring our products are easily accessible and readily available to our customers.



[glasbond.com](http://glasbond.com)

| 1.800.435.0080

| [glasbond@cranecomposites.com](mailto:glasbond@cranecomposites.com)

THE FOLLOWING ARE TRADEMARKS OF CRANE COMPOSITES, INC. OR A RELATED COMPANY: GLASBOND, GLASBORD, KEMLITE, KEMPLY, SURFSEAL, SANIGRID, SILHOUETTE TRIMS AND VARIETEX  
Form 7927 | 06.25 (10356)